

2105 STRAITS VIEW ROAD

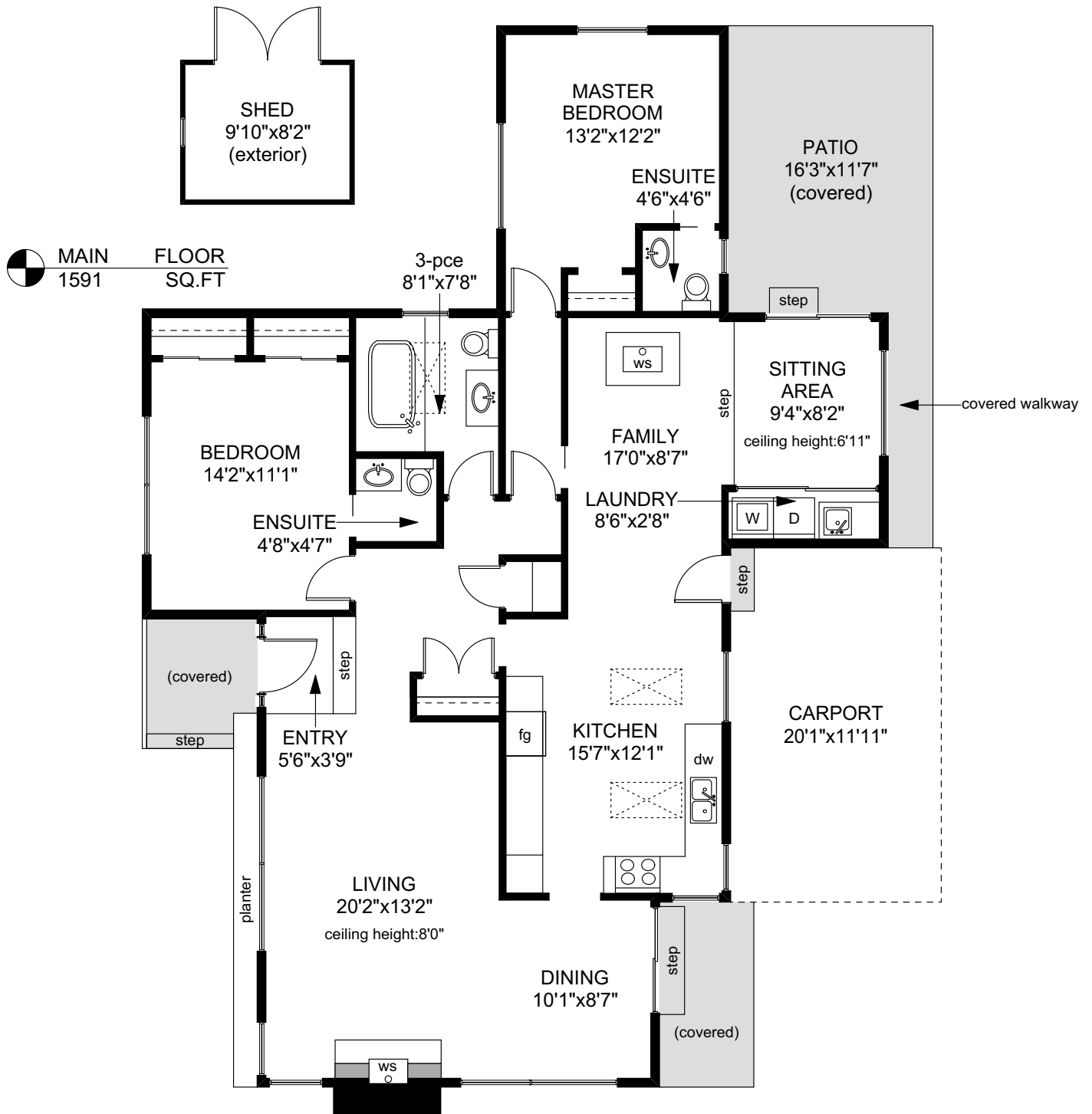

MAIN FLOOR
1591 SQ.FT

	FINISHED SQ. FT.	UNFINISHED SQ. FT.	TOTAL SQ. FT.
MAIN	1591	0	1591
TOTAL	1591	0	1591
CARPORT	0	239	239
SHED	0	80	80
PATIO	0	188	188

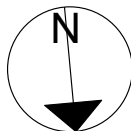

PREPARED FOR THE EXCLUSIVE USE OF
LESLEE FARRELL, ASSOCIATE BROKER,
MACDONALD REALTY Ltd.

MEASURED ON: 07/20/18
DRAWING FILE: 17233

Tafmeasure VICTORIA, B.C.
Ph. 883.8894
www.tafemeasure.com